

CompaCLEAN

(U.S. power supply)

HIGH PRESSURE SPRAY-IN-AIR CLEANING SYSTEM



Standard inner basket space (other on request). With bottom basket only:

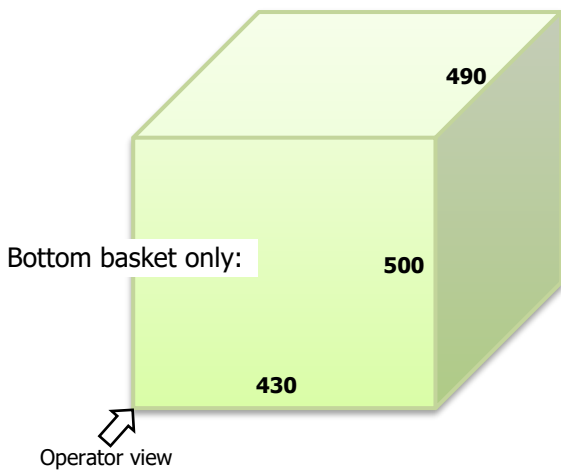

Standard inner basket space (other on request). Bottom basket, upper basket and centric nozzle system:

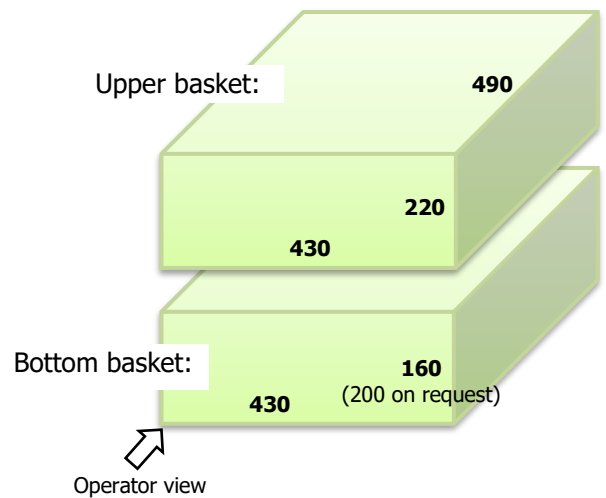

Technical data

- Standard usable space for cleaned material (WxLxH) 480 x 500 x 500 mm (with bottom basket only)
- Standard usable space for cleaned material (WxLxH) 480 x 500 x 160 mm (200 mm on request) and 480 x 500 x 220 mm (with upper basket and centric nozzle system)
- Particular position and space depends on given clamping
- Specific requirements to be consulted with manufacturers' representatives
- Customization available upon request

Machine types

CompaCLEAN II	Wash (Heat to 60 °C) + Tap Water Rinse + Dry
CompaCLEAN III	Wash (Heat to 60 °C) + 1 st Rinse (Tap water or DI water) + 2 nd Rinse (DI water) + Dry

Process data

(Use, capacity and consumption of machine)

Typical consumption of cleaning agent w/o load (per one cycle)	0.15 liter
PCB defluxing and Misprints – max usable area at the disposal	2.55 m ²
Standard max. components height from front side + rear side	40 mm (other on req.)
Max load in 3U–160 eurocards (100x160mm) per one cycle	140 pcs
PCBA + Misprints 3U–160 eurocards (100x160mm) typical total cycle time	60–80 min
PCBA + Misprints 3U–160 eurocards (100x160mm) typical quantity per hour	Up to 140 pcs
PCBA + Misprints typical consumption / cycle (depends on PCB shape and pollution)	0.3–0.4 liter
Solder pallets – available space (necessary to specify clamping)	480 x 500 x 500 mm
Solder pallets typical quantity per hour	4–6 pcs
Typical total cycle time for solder pallets	45–60 min

Typical consumption and typical time are based on values from the field, however cannot be guaranteed because of other factor influence.

Technical parameters

Machine dimension (WxLxH)	1050 × 1700 × 2140 mm
Weight (without liquid)	440–490 kg
Machine noisiness	L _A <70 dB
Power supply voltage	3x 120 V/ 208 V, 60 Hz
Power input	15–21 kVA

Adjustable parameters

All the parameters are adjusted by means of the LCD touch screen.

Washing time (all types)	0–99 min.
Washing medium temperature (optional)	Up to 60 °C
Rinsing time (all types)	0–99 min.
Rinsing temperature (optional)	Up to 40 °C
Conductivity (II, IIR, IIR+,III)	0–999 μS/cm
Drying time (all types)	0–99 min.
Drying temperature (all types)	Up to 110 °C
Number of program registers (settings)	99

Note: All the adjusted parameters are not changed when the power supply is switched on or off.

Technological parameters

Standard – S	Not possible – N	II	III	
Power input (according to configuration)		15–20	16–21	kVA
Washing – pressure on the nozzles max/min (sprayed from all 69 nozzles)		2,3/1,7	2,3/1,7	bar
Washing – max. flow (sprayed from all 69 nozzles)		140	140	l/min
Washing – pressure on the nozzles max/min (sprayed from 33 upper nozzles)		3,6/3,1	3,6/3,1	bar
Washing – max. flow (sprayed from 33 upper nozzles)		85	85	l/min
Rinsing w/o chemical filters – pressure on the nozzles max/min (sprayed from all 69 nozzles)		0,6/0,1	0,6/0,1	bar
Rinsing w/o chemical filters – max. flow (sprayed from all 69 nozzles)		70	70	l/min
Rinsing w/o chemical filters – pressure on the nozzles max/min (sprayed from 33 upper nozzles)		1,7/1,2	1,7/1,2	bar
Rinsing w/o chemical filters – max. flow (sprayed from 33 upper nozzles)		58	58	l/min
Rinsing with chemical filters – pressure on the nozzles max/min (sprayed from all 69 nozzles)			0,3/0	bar
Rinsing with chemical filters – max. flow (sprayed from all 69 nozzles)			50	l/min
Rinsing with chemical filters – pressure on the nozzles max/min (sprayed from 33 upper nozzles)			1,3/0,8	bar
Rinsing with chemical filters – max. flow (sprayed from 33 upper nozzles)			50	l/min
Washing tank volume max/min		71/35	71/35	l
Rinsing tank volume max/min		60/35	35/18	l

Note: Approximate values of pressure and flow are stated. The real values can be a bit different depending on the tolerances of used components. These differences have no effect on cleaning

Dimensions

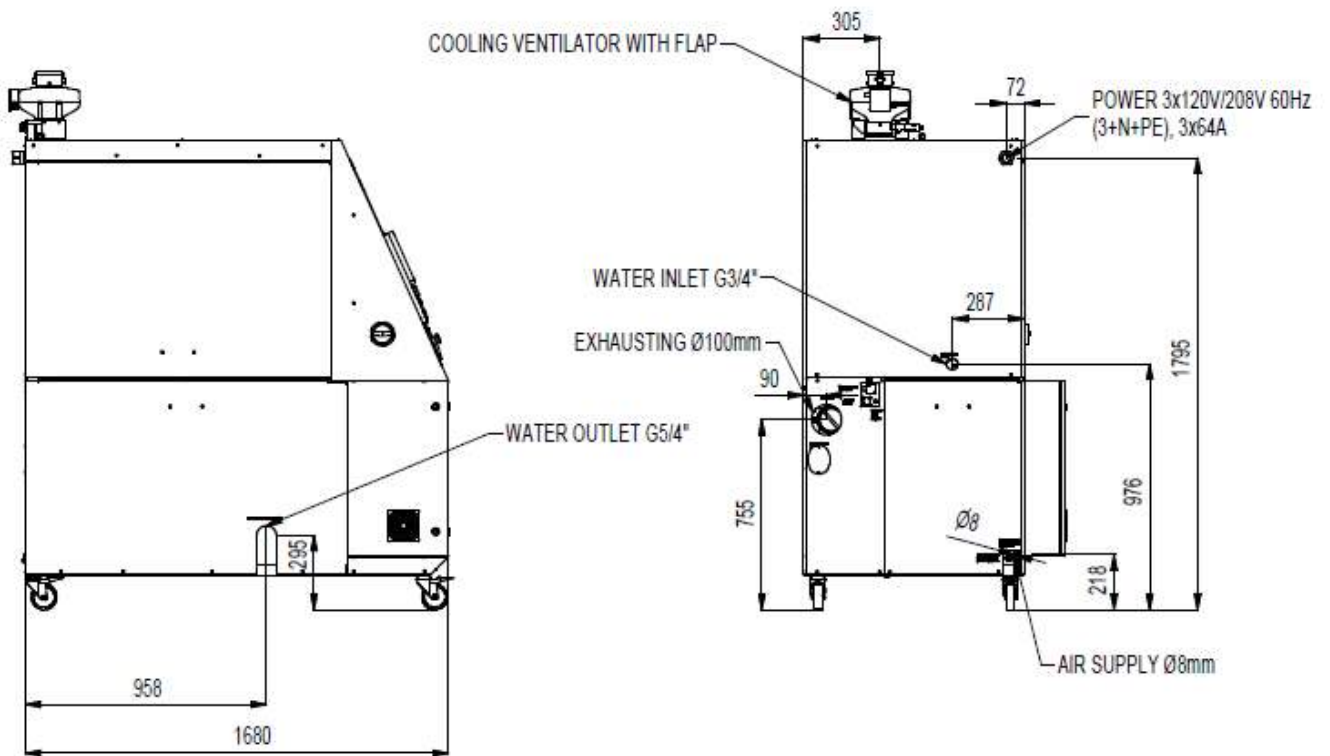
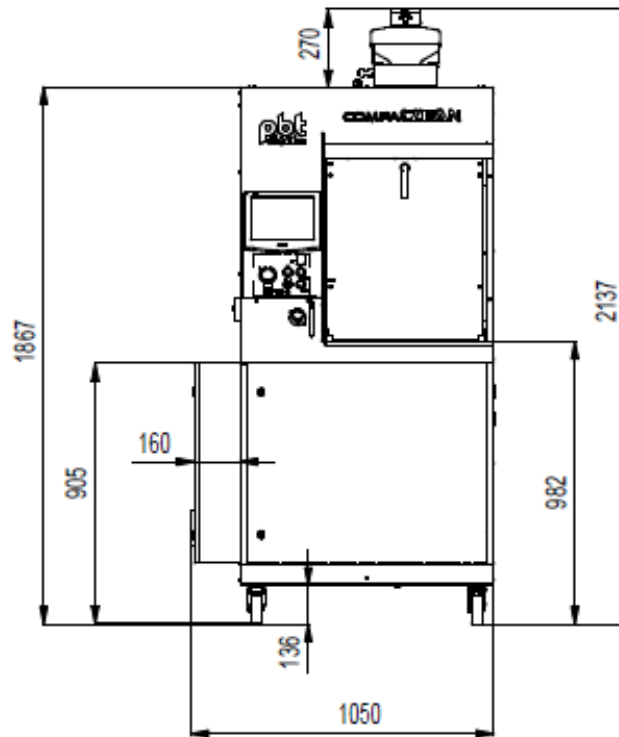

Required service and maintenance area

From the front side of the machine minimally 0,8 m – area for machine operation and accessing area into the switchboard box

From the left side min. 0,8 m – area for machine service and maintenance

From the right side min. 0,1 m

The machine rear part min. 0,2 m – central exhaust system connection

The height of the machine = **2,14 m**

The height of machine with signal tower for indication of machine status (optional) = 2,22 m

The width of machine with pump unit of drain water (optional) = 1,13 m

